

## AMPUR MP - WALL SYSTEM

### PRODUCT DATA SHEET

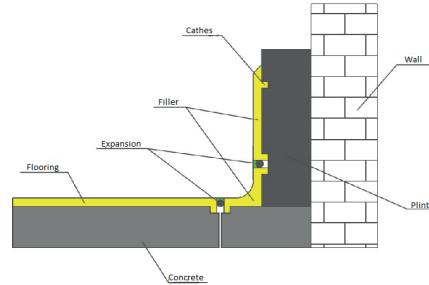

#### Description:

AMPUR MP – WALL SYSTEM is a multi-component system that consists of mineral polyurethane - polyurea composite materials. It is composed of sealing and fullering substance (MP PRIMER), intermediate leveling – filling layer (MP PUTTY) and colourant, surface finishing layer (MP COATING). Priming and finishing layers are applied with a brush and spread with a paint roller. Putty layer is applied with the proper thickness, using plaster – filling technique, then smoothed by floating.

#### Use:

Considering good application and performance parameters, the product can be suitable for places, where high resilience parameters are desirable.

#### Properties:

Thanks to special selection of types and fractions of aggregate and additives, it is possible to achieve a thixotropic substance that facilitates application of the material on vertical surfaces and forming wall roundings

All AMPUR EP materials and systems are characterized by high mechanical, chemical, thermal and biological resistance, as well as short curing time. Due to the diffusive nature they can be applied on high humidity surfaces.

#### Substrate:

All AMPUR MP surface systems can be applied on properly prepared surfaces with appropriate bearing capacity.

The typical surface is seasoned and dry concrete of a minimum class of C 25/30. Consistency (detachment) - min. 1.5 MPa

The surface should be leveled, absorptive and cleaned of lime milk and external materials.

Temperature: 10 - 20 °C (+3 °C higher than the dew point) .

Humidity: max. 6 %.

#### Properties:

Resistance to destructive factors (mechanical and temperature ) will largely depend on the quality and preparation of the surface and the thickness of the solution. The thicker the systems are, the higher are the parameters.

Compression strength	- min. 50 MPa
Tension strength	- min. 5,0 MPa
Bending strength	- min. 10,0 MPa
Concrete detachment	- concrete breaking (min. 2,5 MPa )
Abrasion	- AR < 1
Impact	- IR > 10
Spread of flame	- Bfl - S1
Thermal resistance 4 / 6 / 9 mm	- 60 / 85 / 100

#### Application examples (AMPUR MP - WALL SYSTEM, thickness of 3.0 mm):

- prepare and prime the surface - as per AMPUR MP Material Application Manual
- AMPUR MP PRIMER consumption- about 0,5 – 1,0 kg/m<sup>2</sup> (depending on the surface roughness)
- prepare AMPUR - MP PUTTY material, fill in and smooth out all the holes
- prepare AMPUR - MP PUTTY material, apply and smooth on the wall surface, to a desired thickness
- prepare AMPUR - MP PUTTY material and form so-called wall rounding
- prepare AMPUR - MP COATING material and apply with paint brushes, then spread into a uniform texture using paint rollers
- restore and fill the expansion joints using AMPUR PU EXPANSION system

PPHU AMPUR Piotr Mundzia ensures a high quality of products and takes responsibility for any damages to the materials supplied. However, operating and ambient conditions, as well as material preparation and application are beyond our control, hence, no liability is expressed in terms of the final effect of the materials used at the Construction Site. All materials can be used only by trained and experienced Staff, in accordance with application and ambient recommendations specified in the Application Manual for AMPUR MP Materials. All the information and recommendations are based on our extensive knowledge and experience.

Prior to use, the substrate, ambient conditions and quality of the materials should be inspected. In case of any doubts or non-standard use, please consult our sales representatives.

This document remains effective until the new version is issued.

Issue date: 01.01.2014